



## GLAZED FIRE DOOR

A glazed fire door is a type of fire-rated door that incorporates one or more glass panels within its structure. Our Door is constructed from materials that needs specific Fire Resistant Standards such as IS 16947 & other similar Standards. Designed to prevent the spread of fire and smoke while allowing visibility and natural light, it features specially engineered fire-resistant glass that meets stringent safety standards. These doors are installed in fire-resistant frames and constructed from materials such as timber or steel, with the glass panels maintaining the door's fire rating by withstanding high temperatures and minimizing heat transfer. Glazed fire doors are commonly used in both commercial and residential buildings to balance fire safety with aesthetic and functional needs.



Our Glazed Fire Door has been Tested for

INTEGRITY



STABILITY



INSULATION



Sr. No.		FIRE RATED DOOR	GENERAL DOOR
1	Shutter Material	G.I. 1.6mm	G.I. 1.6mm
2	Frame Material	G.I. 1.6mm, 2mm	G.I. 1.6mm
3	Shutter Thickness	46mm	
4	Frame Profile	100x57, 143x57mm	100x57mm
5	Rebat	Single and Double	Single
6	Fixing	Anchor Bolt, Hold Fast	Anchor Bolt, Hold Fast
7	Reinforcement	3mm Wherever it is required	2mm Wherever it is required
8	Packing	As per Customer Requirement	As per Customer Requirement
9	Finishing	Painting/Powder Coating as per Customer requirement	Painting/Powder Coating as per Customer requirement

### HARDWARES

10	Lock	Mortice Lock, Dead Lock, Panic Bar, Latch	Shaft Lock, Aldrop, Night Latch
11	Handle	Lever Handle, D Handle, External Trim	Flush Handle, D Handle
12	Vision Glass	6mm, 2Hr, Fire Rated Glass (min 200x300mm) Size as per Customer requirement	6mm Toughened Glass as per Customer requirement
13	Hinges	SS Ball Bearing Hinges 4"x3"x3mm	SS Ball Bearing Hinges 4"x3"x3mm
14	Door Closer	Hold Open arm, Concealed, as per Customer requirement	Hold Open arm, Concealed, as per Customer requirement
15	Flush Bolt	Tower Bolt, Flush Bolt (For Double Doors)	Tower Bolt, Flush Bolt (For Double Doors)
16	Seals	Smoke Seal, Intumescent Seal, Door drop seal as per Customer requirement	Smoke Seal, Intumescent Seal, Door drop seal as per Customer requirement

Address : Village Nimbua, Derabassi  
Call : 7696426719

**Frame Section of 125x75 Single Rebate Profile**

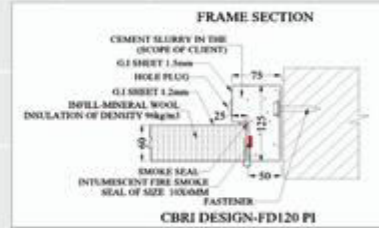

**Frame Section of 125x55 Single Rebate Profile**

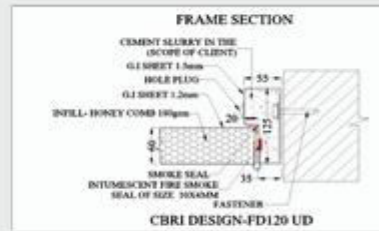

**Frame Section of 100x57 Single Rebate Profile**



**Frame Section of 100x57 Single Rebate Profile**



**Frame Section of Glazed Door (DSR DESIGN)**

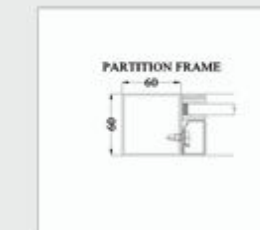
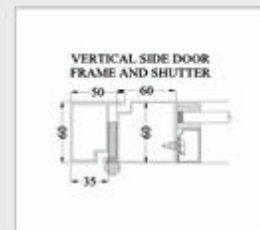

### A) HINGED TYPE (SINGLE LEAF)

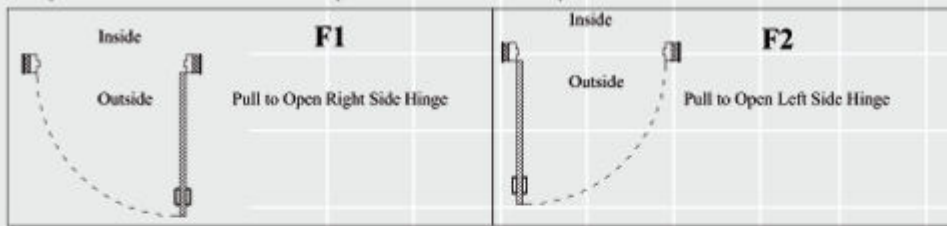

### B) HINGED TYPE (DOUBLE LEAF - EQUAL LEAF)



### C) HINGED TYPE (DOUBLE LEAF - UNEQUAL)

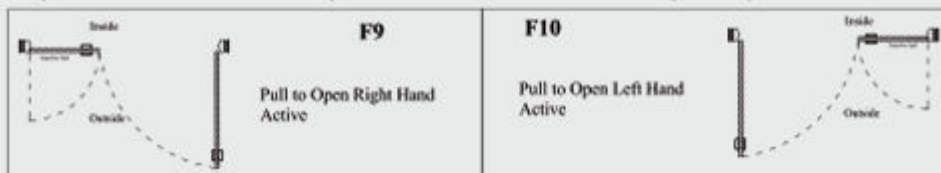

#### QUICK HARDWARE SECTION GUIDE

ITEM DESCRIPTION	Location				
	Fire Staircase	AHU Rooms	Service Rooms	Shaft	Lift Lobby
<b>Recommended</b>					
as ball Bearing Hinges (100x75x3 / 100x80 mm)	✓	✓	✓	✓	✓
Door Closer	✓				✓
Panic Bar / Latch	✓				
Panic Trim / Latch & Lock	✓				
Mortise Dead Lockset		✓	✓		✓
D shape pull handles		✓	✓		✓
Mortise Sash lockset				✓	
Vision panel (single layered only)	✓	✓	✓	✓	
Fasteners	✓	✓	✓	✓	✓
Fire Seal	✓	✓	✓	✓	✓
Smoked seal	✓	✓	✓	✓	✓



### Rock Wool / Mineral Core

- ✓ ROCKWOOL stone wool products are made of basalt, a volcanic stone, which is the world's most abundant natural resource.
- ✓ ROCKWOOL stone wool products are non-combustible with a melting point more than 1000 °C. They are particularly suitable for thermal insulation, fire protection and sound reduction
- ✓ ROCKWOOL stone wools inorganic and contains no nutritious substance. Therefore it will not be attacked by
- ✓ No CFCs, HFCs, HCFCs, or asbestos are used in the manufacture of ROCKWOOL stone wool products
- ✓ Insulated door VP Size (upto 0.06 sqm) 200mm x 300mm / 150mm x 400mm
- ✓ Common Density of wool is 96kg/m<sup>3</sup>, commonly used for fire doors.

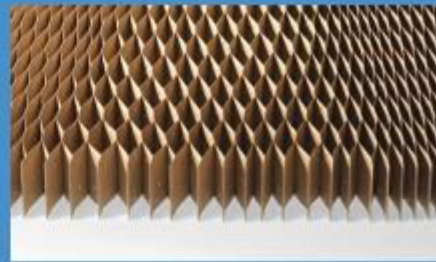

### Honeycomb Core

- ✓ Honeycomb core is made from layers of paper or cardboard together by parallel & uniformly spaced lines of adhesive, lightweight & high strength.
- ✓ Glued to the interior surface of the door skin door leaf is the pressed for a couple of hours to maintain the flatness of the door.
- ✓ Compressive strength is equal to 1.4 kg/cm<sup>2</sup>, commonly used for fire rated doors

## Vision Panel

- ✓ Door Leaf can be provided with vision panel for visibility. Sizes of the same can be customised or as per approved drawing Un-Insulated door VP size (upto 0.12sqm) e.g.300mm x 400mm /150mm x800mm partially & fully insulated Insulated door VP size (upto 0.06 sqm) e.g.200mm x 300mm /150mm x 400mm

